



# TECH BULLETIN

**116**  
10/12

*Published regarding engineering changes and improvements*

**SUBJECT: 152R-Series Valve Assembly Change**

Models 152R060/C, 152R080/C, 152R100/C

The valves have been change to improve the performance. When ordering replacement parts the valve (166), valve spring (167) and spring retainer (168) all need to be changed together. The old and new cannot be used together. The valve seat (164) and Stud (171) did not change.

**Previous Design**

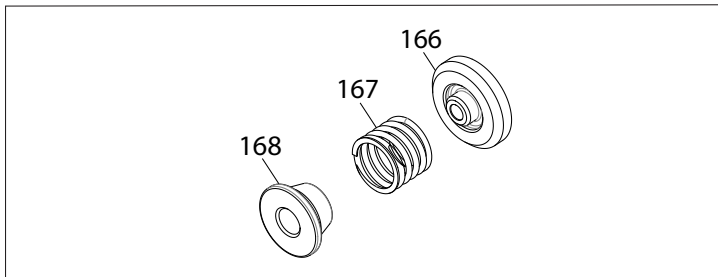

**Current Design**

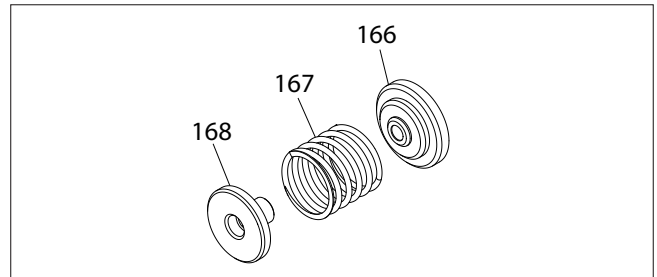

**PREVIOUS PART NUMBER**

ITEM NUMBER	DESCRIPTION	PART NUMBER
166	Valve	890251
167	Valve Spring	890320
168	Spring Retainer	890301

**CURRENT PART NUMBER**

ITEM NUMBER	DESCRIPTION	PART NUMBER
166	Valve	890427
167	Valve Spring	890428
168	Spring Retainer	890429

CAT PUMPS  
Technical Services Department